



EV-6 type SOLENOID VALVE FOR GAS

Model/Ref: 092502M



*Partnership.
Without Limits.*

www.lauridsenindustri.com

EV-6 type SOLENOID VALVE FOR GAS

CHARACTERISTICS

The EV-6 solenoid valve is a safety device dedicated to the equipment of gas systems below a pressure of 6 bar. It complies with the EN161 standard. It has an aluminium construction with NBR gaskets and is suitable for town gas, natural gas, liquefied petroleum gas and other non aggressive gases. Normally closed, this solenoid valve opens with electric supply. In case of power cut, the valve closes instantly. It can be installed in ATEX zone 2 and 22.

AVAILABLE ITEMS

Aluminium body, NBR gaskets
 Closing time < 1 s
 Sizes: 1/2" to 2" and DN 65 to DN 100
 BSP threaded connections
 ISO PN 16 flanged connections
 Voltage: 230 V AC



LIMITS OF USE

Max. allowable pressure (PS)	6 bar (20 °C)
Min. / max. allowable temperature (TS)	-20 °C / +60 °C

DIRECTIVES AND CONSTRUCTION STANDARDS

	Standard	Notified bodies
EC 97/23 Pressure Directive		CSI #0497
EC 2009/142 Gas Appliance Directive	EN 161	IMQ #0051
ATEX EC 94/9 Directive	II 3 G/D (zones 2 and 22)	

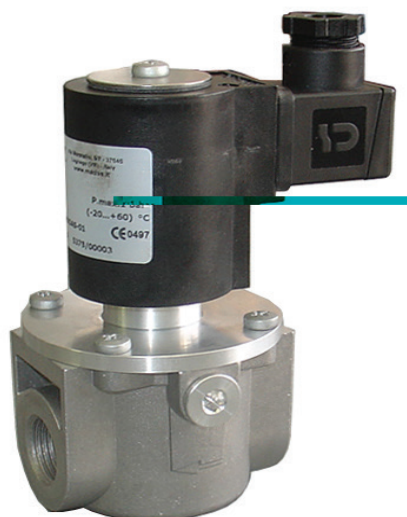

Technical data given for information purpose only. May be subject to alteration without prior notice

EV-6 type SOLENOID VALVE FOR GAS

CONSTRUCTION

#	Item	#	Item
1	Electrical connector	8	Bottom fixing screw
2	Gasket	9	Pressure test cap
3	Closing spring	10	Bonnet fixing screw
4	Solenoid valve body	11	Bonnet
5	Obturator	12	Electrical coil
6	Bearing gasket	13	Coil fixing nut
7	Bottom		

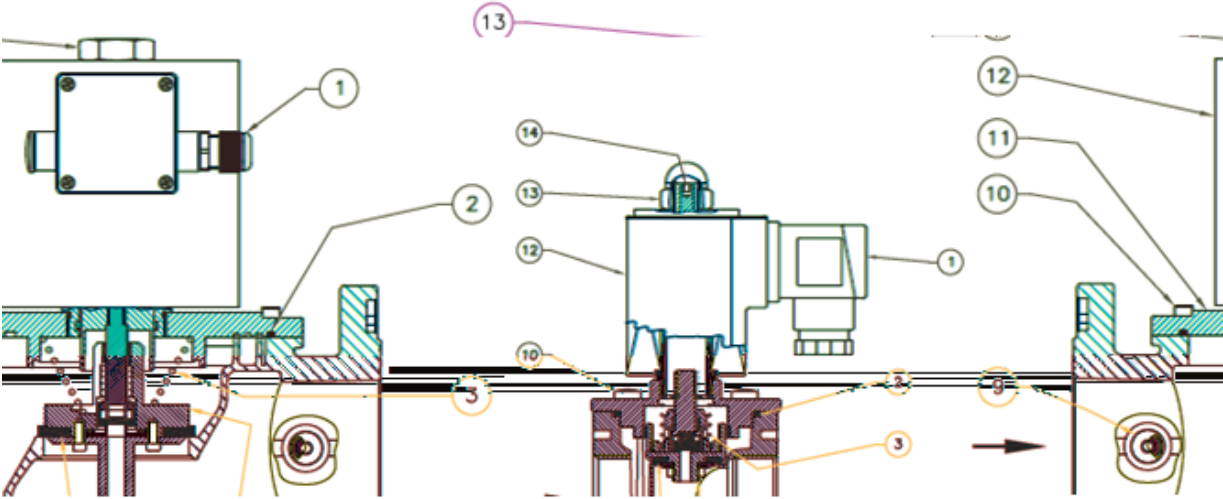

Technical data given for information purpose only. May be subject to alteration without prior notice

EV-6 type SOLENOID VALVE FOR GAS

DIMENSIONS (mm)

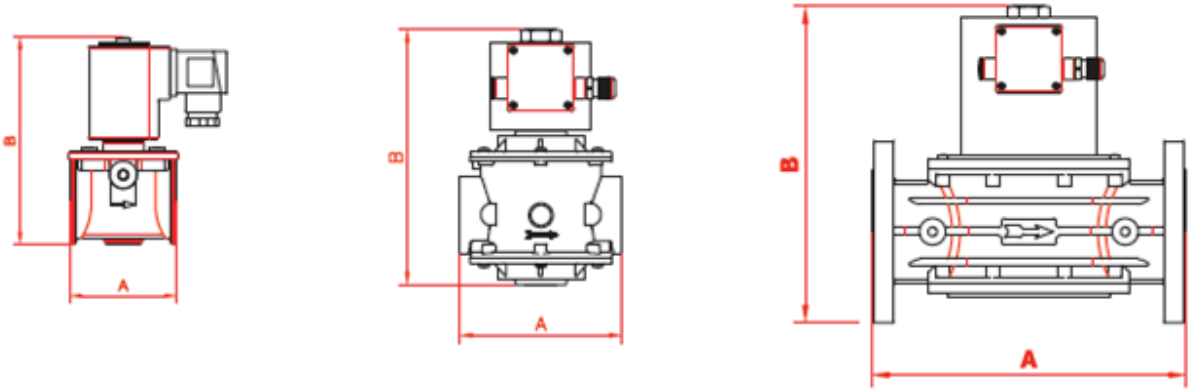

DN	1/2"	3/4"	1"	1"1/4	1"1/2	2"	65	80	100
A	70	70	70	160	160	160	290	310	350
B	137	137	137	258	258	258	318	325	392

PRESSURE DROP DIAGRAM

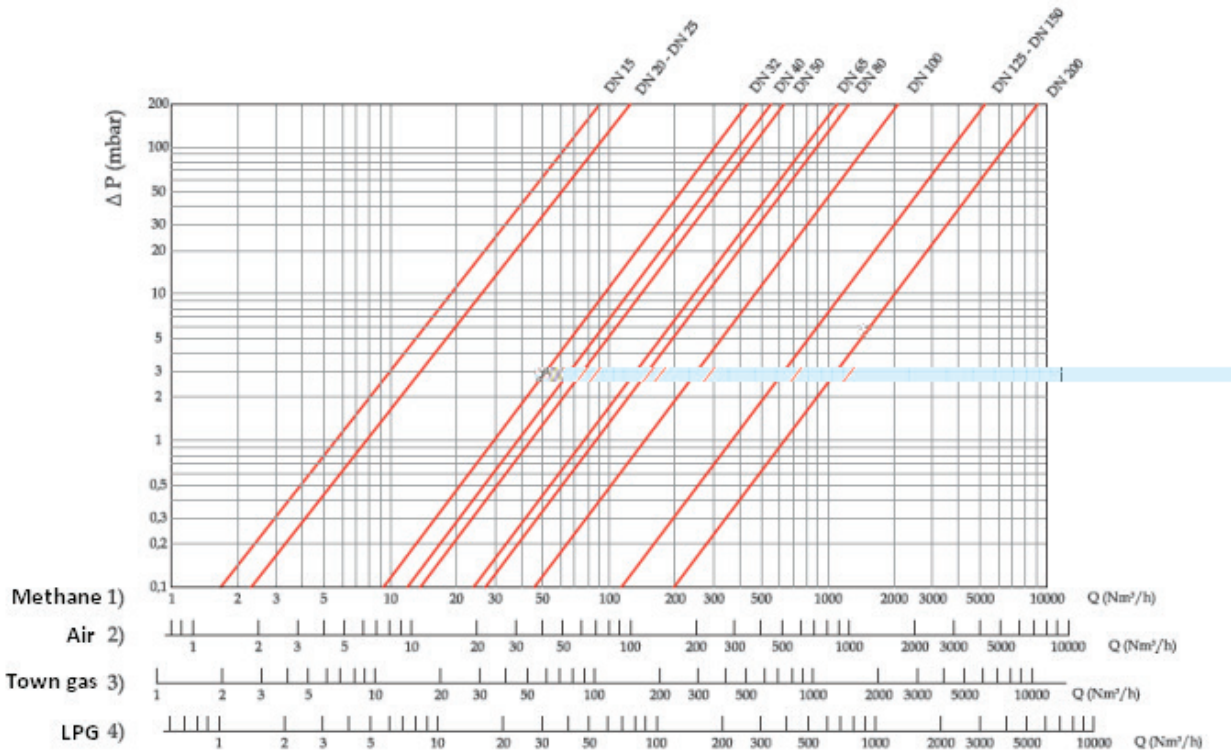

Technical data given for information purpose only. May be subject to alteration without prior notice

EV-6 type SOLENOID VALVE FOR GAS

INSTALLATION IN ATEX ZONE

The EV-6 solenoid valve complies with the ATEX Directive EC/94/9 and is included in group II devices, category 3 G/D. It can be installed in zones 2 and 22.

The device does not constitute any hazard as long as it is installed and maintained following all the conditions and technical instructions mentioned in this document. In normal operating conditions, the solenoid valve is not supposed to emit flammable substances in the atmosphere that might cause an explosion hazard.

MOUNTING AND MAINTENANCE

Warning: Installation and maintenance operations must be carried out by qualified technicians only.

1°/ Shut off the gas supply before installation. Depressurize the piping system. Ventilate the area.

2°/ Check that the line pressure does not exceed the maximum pressure indicated on the device label (6 bar)

3°/ The solenoid valve is normally positioned before the point of use. The arrow marked on the body has to be directed to the point of use.

4°/ Do not install the solenoid valve with the coil facing downwards.

5°/ During the installation, make sure that no metal residues or particles get into the device.

6°/ After the mounting, please check the device tightness.

7°/ Before carrying out the electrical connections, please check that the network voltage matches the coil power supply voltage. Please also check that there is no under pressure gas inside the device.

8°/ A yearly verification is necessary for the device effective operation.

OPTIONS

Voltage: 12 V AC, 12 V DC, 24 V AC, 24 V DC, 110 V AC

Size: DN 125 to DN 200

Technical data given for information purpose only. May be subject to alteration without prior notice