

1700 SERIES UFR+L COMBINATION

GENERAL CHARACTERISTICS

- Filter regulator + lubricator combination for compressed air or neutral gases
- Maximum input pressure: 10 bar
- Minimum input pressure: 0.5 bar
- Room temperature: - 10 °C /+ 60 °C.
- Operating temperature: 0 °C/+ 50 °C.
- Maximum flow rate and tank capacity: refer to the below table
- Connection: BSP 1/4" to 1"
- Delivered with a mounting bracket
- ISO 9002 construction
- Regulator accuracy: 0.2 bar

SPECIFIC CHARACTERISTICS

Filter regulator

- Lockable control
- Regulation by piston
- Semi-automatic drain
- Delivered with a 1/4" DN 53 mm 0-10 bar/150 psi manometer
- Filtration rating 5 µ

Lubricator

- Oil fill under pressure
- Oil flow adjustment
- Recommended oil: VG32 (ISO 3448)

CONSTRUCTION

Aluminium body
Polycarbonate bowl
Fiberglass reinforced polyamide protector

OPTIONS

Panel mounting ring
Intermediate block with tapping connexion

FLOW RATE AND CAPACITY

UFR/L	Ø	Max. flow rate	Pressure (bar)		Capacity (cm ³)	
		l/min	Min.	Max.	Filter	Lubricator
02	1/4"	2 080	0,5	10	105	125
03	3/8"	2 100	0,5	10	105	125
04	1/2"	2 600	0,5	10	105	125
06	3/4"	7 940	0,5	12	210	235
08	1"	8 200	0,5	12	210	235

DIMENSIONS

Ø	A	B	C	D	E	Weight (kg)	
						U.FR	U.L
1/4"	74,3	128	64	92	58,5	0,93	0,5
3/8"	247	128	64	92	58,5	0,93	0,5
1/2"	247	128	64	92	58,5	0,93	0,5
3/4"	270	179	69,5	86	63	1,36	1,09
1"	270	179	69,5	86	63	1,36	1,06

Technical data given for information purpose only. May be subject to alteration without prior notice

1700 SERIES UFR+L COMBINATION

FLOW RATE/PRESSURE DROP CHARACTERISTICS

Filter regulators

Black curve: input pressure (P1)
 Grey curve: output pressure (P2)
 Pressure drop = P1 - P2

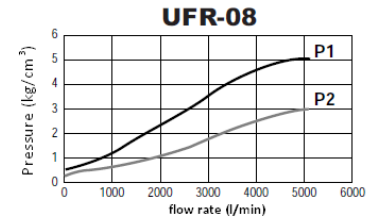
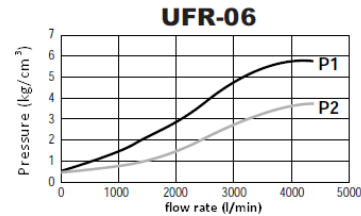
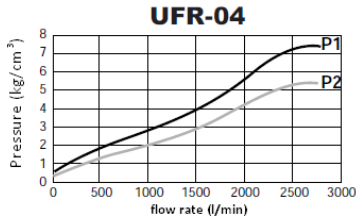
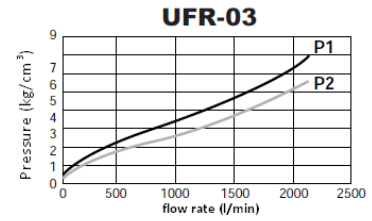
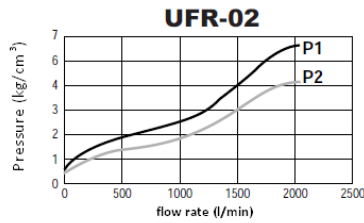

Lubricators

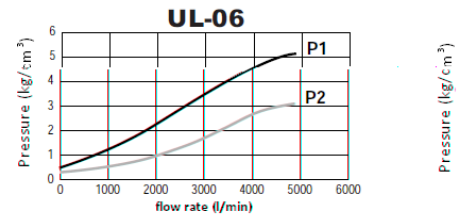
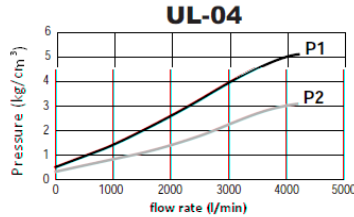
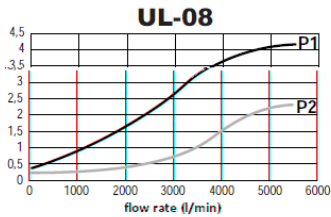
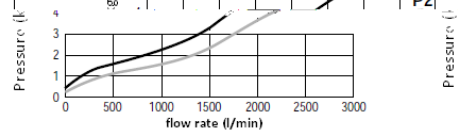
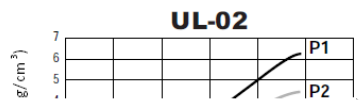
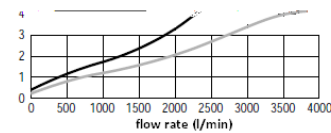

INSTALLATION AND USE INSTRUCTIONS

Installation

The device should always be mounted in a horizontal position.

The supply should follow the direction of the arrow marked on the body.

- For UFR/L 02, 03 and 04, remove the plastic cap to mount the fixing plate.
- For UFR/L 06 and 08, the fixing plates are directly fixed on lateral modules.

Use

Rotate the pressure adjustment screw clockwise to increase the pressure and anti-clockwise to reduce it. The impurities collected in the filter bowl can be easily evacuated by the semi-automatic drain system. The lubricator filling can be made by the lateral orifice. It can be open using an Allen key. Please use the specified type of oil. To adjust the oil flow, please use the dedicated top cover adjusting screw.

WARNING: It is compulsory to depressurize the device before removing the lubricator and the filter bowls.

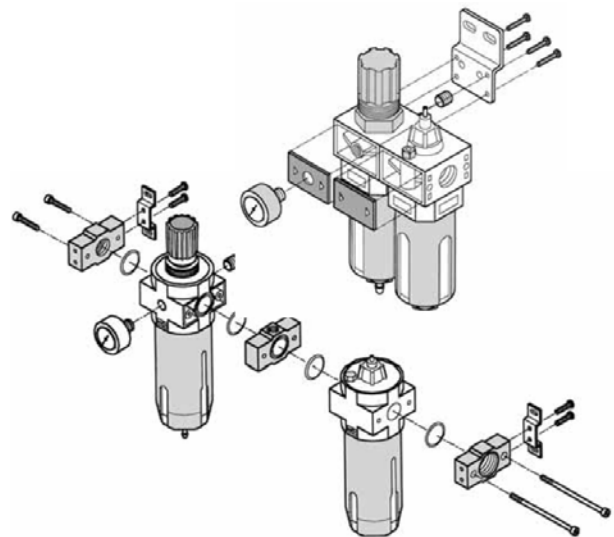

Technical data given for information purpose only. May be subject to alteration without prior notice