

**CARBON STEEL Y STRAINER PN 40**



PED 2014/68/EU



**Certificate 3.1**

**Size :** DN 15 to DN 300  
**Ends :** Flanged R.F. PN25/40  
**Min Temperature :** - 29°C  
**Max Temperature :** + 425°C  
**Max Pressure :** 40 Bars  
**Specifications :** Stainless steel removable filter  
Bolted bonnet with draining cap

**Materials :** Carbon steel ASTM A216 WCB

**CARBON STEEL Y STRAINER PN 40**
**SPECIFICATIONS :**

- Removable stainless steel filter
- R.F. Flanged PN25/40 , PN40 from DN200 to 300
- Horizontal or vertical position with descendant fluid (respect the flow direction indicated by the arrow)
- Mesh 1mm up to DN 50 , 1.25 mm from DN 65 to 80, 1.6 mm from DN100 to 200, 4 mm over
- Bolted bonnet with draining cap threaded BSP
- Blue painting RAL 5002, 80 µm thickness

**USE :**

- For all common fluids
- Min Temperature Ts : - 29°C
- Max Temperature Ts :+ 425°C
- Max Pressure Ps : 40 bars ( see graph )

**PRESSURE / TEMPERATURE RELATION ( STEAM EXCLUDED ) :**

| Temperature (°C) | -29  | -10 | 120 | 200  | 250  | 300 | 350 | 400 | 425 |
|------------------|------|-----|-----|------|------|-----|-----|-----|-----|
| Pressure (Bar)   | 25.8 | 40  | 40  | 34.7 | 31.4 | 28  | 24  | 21  | 18  |

**FLOW COEFFICIENT Kvs ( M3 / h ) :**

| DN           | 15  | 20   | 25   | 32   | 40   | 50 | 65   | 80  | 100 | 125 | 150 | 200 | 250  | 300  |
|--------------|-----|------|------|------|------|----|------|-----|-----|-----|-----|-----|------|------|
| Kvs ( m3/h ) | 6.2 | 10.8 | 16.8 | 26.1 | 36.7 | 61 | 98.6 | 146 | 234 | 376 | 405 | 752 | 1220 | 1865 |

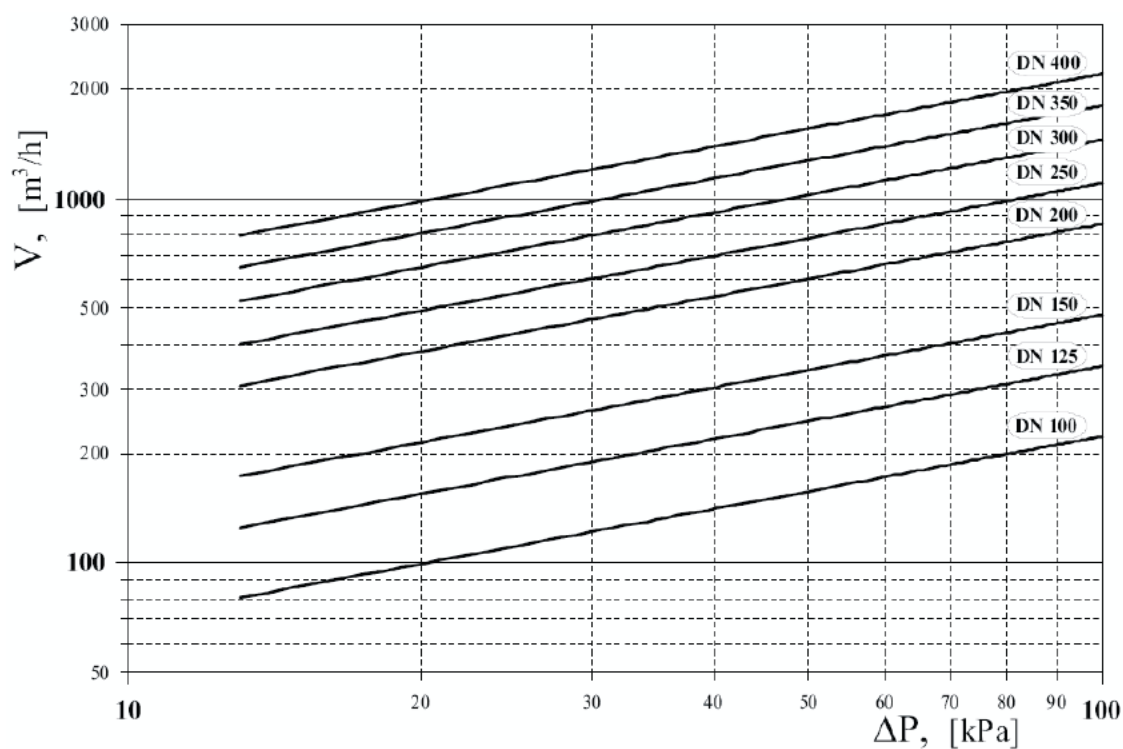
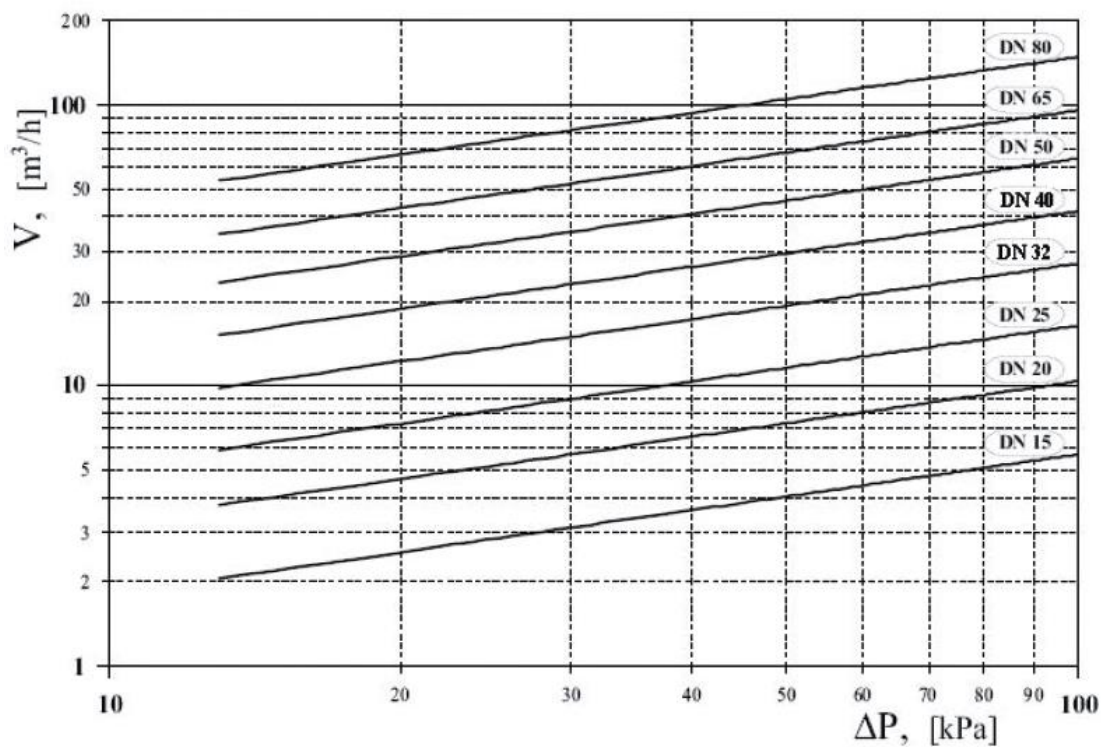
**CARBON STEEL Y STRAINER PN 40**
HEAD LOSS :

**CARBON STEEL Y STRAINER PN 40**
**RANGE :**

- Carbon steel flanged R. F. PN25/40 DN 15 up to DN 150 and PN40 from DN200 to DN300 Ref.235
- Carbon steel flanged male-female facing PN25/40 from DN 15 up to DN 80 Ref.2353

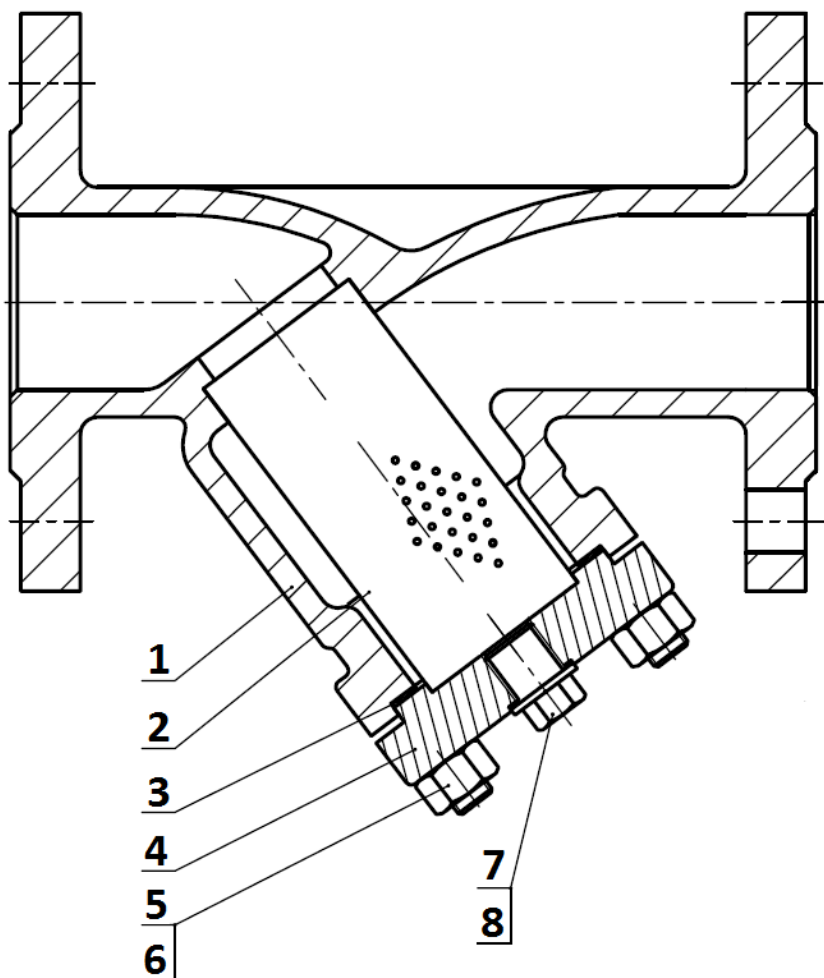
**MATERIALS :**

| Item | Designation   | Materials           |
|------|---------------|---------------------|
| 1    | Body          | ASTM A 216 WCB      |
| 2    | Filter        | AISI 304            |
| 3    | Bonnet gasket | Graphite + AISI 304 |
| 4    | Bonnet        | ASTM A216 WCB       |
| 5    | Stud          | A193-B7             |
| 6    | Nut           | A194-2H             |
| 7    | Plug          | A105                |
| 8    | Plug gasket   | Graphite + AISI 304 |

**CARBON STEEL Y STRAINER PN 40**

SIZE ( in mm ) :

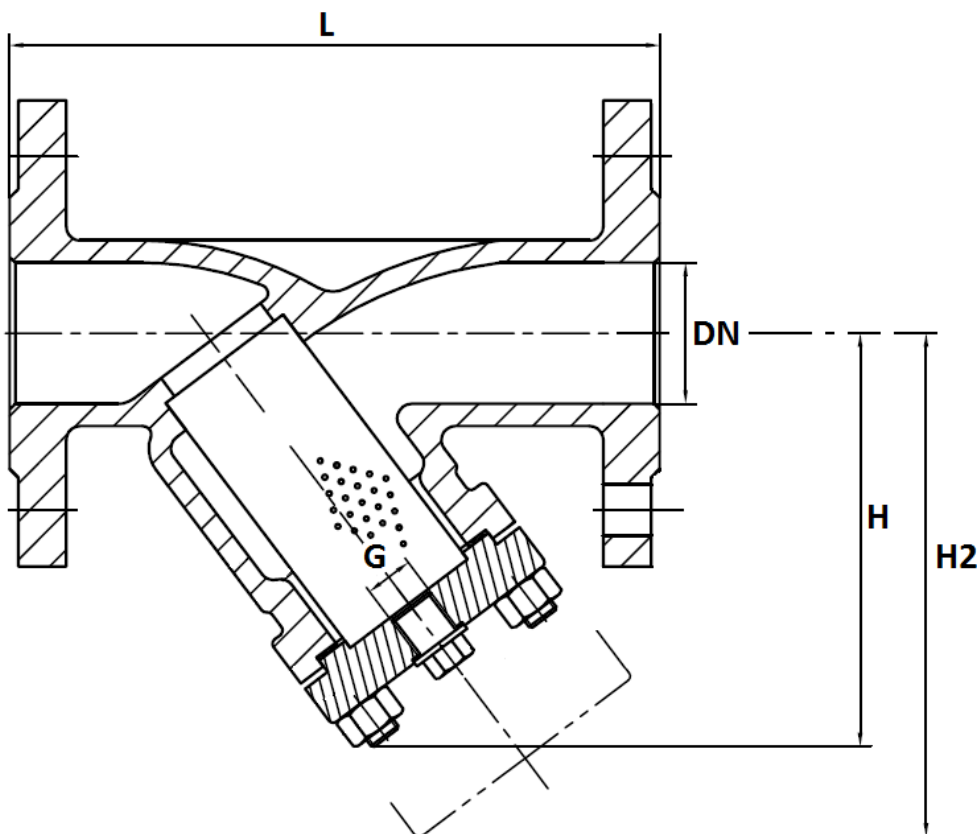

Filter size :

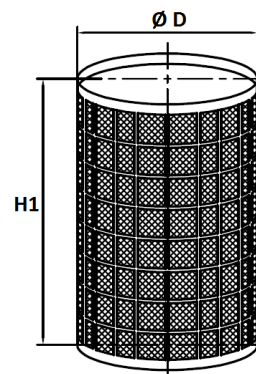

Gasket size :

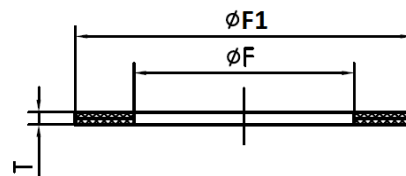

| Ref. | DN            | 15   | 20   | 25   | 32   | 40  | 50   | 65   | 80   | 100    | 125    | 150    | 200    | 250 | 300 |
|------|---------------|------|------|------|------|-----|------|------|------|--------|--------|--------|--------|-----|-----|
| 235  | L             | 130  | 150  | 160  | 180  | 200 | 230  | 290  | 310  | 350    | 400    | 480    | 600    | 730 | 850 |
|      | H             | 98   | 97   | 108  | 113  | 138 | 147  | 170  | 204  | 240    | 288    | 334    | 380    | 535 | 640 |
|      | H2            | 106  | 115  | 122  | 130  | 155 | 165  | 190  | 225  | 265    | 310    | 360    | 427    | 590 | 710 |
|      | G (drain BSP) | 3/8" | 3/8" | 3/4" | 3/4" | 1"  | 1"   | 1"   | 1"   | 1 1/2" | 1 1/2" | 1 1/2" | 1 1/2" | 2"  | 2"  |
|      | Ø D           | 22   | 22   | 29   | 35   | 42  | 52   | 58   | 75   | 104    | 124    | 150    | 190    | 243 | 295 |
|      | H1            | 48   | 59   | 75   | 85   | 97  | 105  | 121  | 150  | 175    | 205    | 240    | 310    | 390 | 458 |
|      | Mesh          | 1    | 1    | 1    | 1    | 1   | 1    | 1.25 | 1.25 | 1.6    | 1.6    | 1.6    | 1.6    | 4   | 4   |
|      | Ø F1          | 50   | 50   | 56   | 56   | 75  | 75   | 92   | 106  | 135    | 170    | 195    | 250    | 335 | 385 |
|      | Ø F           | 40   | 40   | 44   | 44   | 60  | 60   | 75   | 92   | 116    | 150    | 165    | 220    | 295 | 345 |
|      | T             | 1.5  | 1.5  | 1.5  | 1.5  | 1.5 | 1.5  | 1.5  | 1.5  | 1.5    | 1.5    | 1.5    | 1.5    | 1.5 | 1.5 |
|      | Weight (Kg)   | 2.8  | 3.4  | 4.9  | 6.6  | 8.9 | 11.3 | 15.8 | 20.6 | 32.1   | 47.9   | 66     | 135    | 201 | 317 |

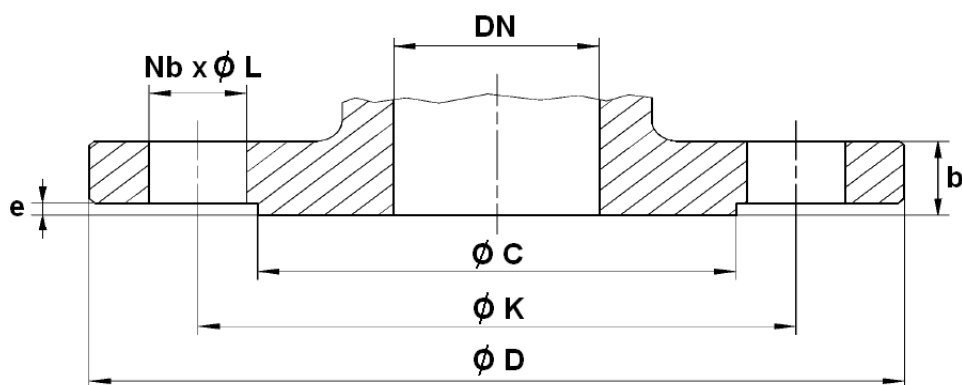
**CARBON STEEL Y STRAINER PN 40**
**FLANGES SIZE ( in mm ) :**

| DN       | 15     | 20     | 25     | 32     | 40     | 50     | 65     | 80     | 100    | 125    | 150    | 200     | 250     | 300     |
|----------|--------|--------|--------|--------|--------|--------|--------|--------|--------|--------|--------|---------|---------|---------|
| Ø C      | 45     | 58     | 68     | 78     | 88     | 102    | 122    | 138    | 162    | 188    | 218    | 285     | 345     | 410     |
| Ø D      | 95     | 105    | 115    | 140    | 150    | 165    | 185    | 200    | 235    | 270    | 300    | 375     | 450     | 515     |
| Ø K      | 65     | 75     | 85     | 100    | 110    | 125    | 145    | 160    | 190    | 220    | 250    | 320     | 385     | 450     |
| Nb x Ø L | 4 x 14 | 4 x 14 | 4 x 14 | 4 x 18 | 4 x 18 | 4 x 18 | 8 x 18 | 8 x 18 | 8 x 22 | 8 x 26 | 8 x 26 | 12 x 30 | 12 x 33 | 16 x 33 |
| b        | 16     | 18     | 18     | 18     | 18     | 20     | 22     | 24     | 24     | 26     | 28     | 34      | 38      | 42      |
| e        | 2      | 2      | 2      | 2      | 3      | 3      | 3      | 3      | 3      | 3      | 3      | 3       | 3       | 4       |

**CARBON STEEL Y STRAINER PN 40****STANDARDS :**

- Fabrication according to ISO 9001 : 2008
- Design according to DIN 3356
- DIRECTIVE 2014/68/EU : CE N° 0036  
Risk Category III Module H
- Certificate 3.1 on request
- Tests according to DIN 3230
- Length according to EN 558 series 1 (DIN 3202-1 F1 – NF 29354)
- Flanges R.F. according to EN 1092-1 PN40

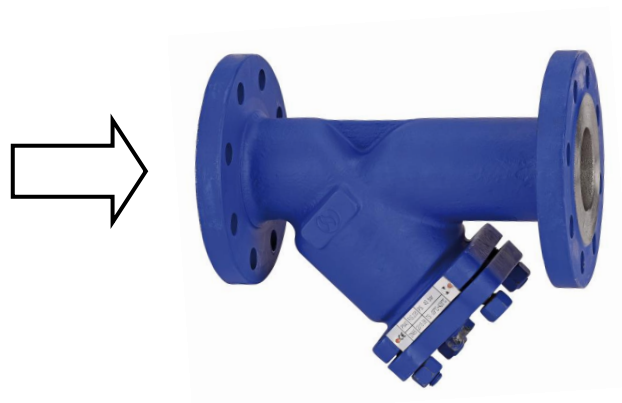
**INSTALLATION POSITIONS :****Vertical position ( descendand fluid )****Horizontal position**

**ADVICE :** Our opinion and our advice are not guaranteed and Lauridsen industri shall not be liable for the consequences of damages. The customer must check the right choice of the products with the real service conditions.

## **CARBON STEEL Y STRAINER PN 40**

### **INSTALLATION INSTRUCTIONS**

#### **GENERAL GUIDELINES :**

- Ensure that the strainers to be used are appropriate for the conditions of the installation (type of fluid, pressure and temperature).
- Be sure to have enough valves to be able to isolate the sections of piping as well as the appropriate equipment for maintenance and repair.
- Ensure that the strainers to be installed are of correct strength to be able to support the capacity of their usage.
- **Installation of all circuits should ensure that their function can be automatically tested on a regular basis (at least two times a year).**

#### **INSTALLATION INSTRUCTIONS :**

- **Before installing the strainers, clean and remove any objects from the pipes** (in particular bits of sealing and metal) which could obstruct and block the strainers.
- **Ensure that both connecting pipes either side of the strainer (upstream and downstream) are aligned (if they're not, the strainer may not work correctly).**
- **Make sure that the two sections of the pipe (upstream and downstream) match, the strainer unit will not absorb any gaps. Any distortions in the pipes may affect the tightness of the connection, the working of the strainer and can even cause a rupture.** To be sure, place the kit in position to ensure the assembling will work.
- Make sure flanges are cleaned.
- **If sections of piping do not have their final support in place, they should be temporarily fixed. This is to avoid unnecessary strain on the strainer.**
- Tighten the bolts in cross.
- The pressurisation must be increased gradually.
- So that the maintenance operations could be easily done, place a stop valve before and after the strainer. Thereby, the strainer could be isolated. During this operation, ensure to have a new bonnet gasket to avoid a leakage during the restarting.
- **Fluids in the strainer must not contain solid objects ( it could damaged the seat ).**